

AUCTION

**Lower Gooromon, Canberra
— adjoins A.C.T.**

1630 hectares (4070 acres) Freehold

**Location suggests great
Capital Gain Potential**

**'For Sale as a Whole and if not
sold in following lots:—**

Date of Sale: Thursday 25th October, 1984

Place of Sale: "Parkwood" Woolshed

Time of Sale: 11 a.m.

"Parkwood" 644ha (1610 acres)

"Glenmoor" 232ha (574 acres)

"Jarramlee" 150ha (390 acres)

Portion 3 251ha (629 acres)

Part Portion 74 213ha (534 acres)

Portions 37, 7 126ha (313 acres)

Portion 13 8ha (20 acres)

Terms available to Approved Purchasers

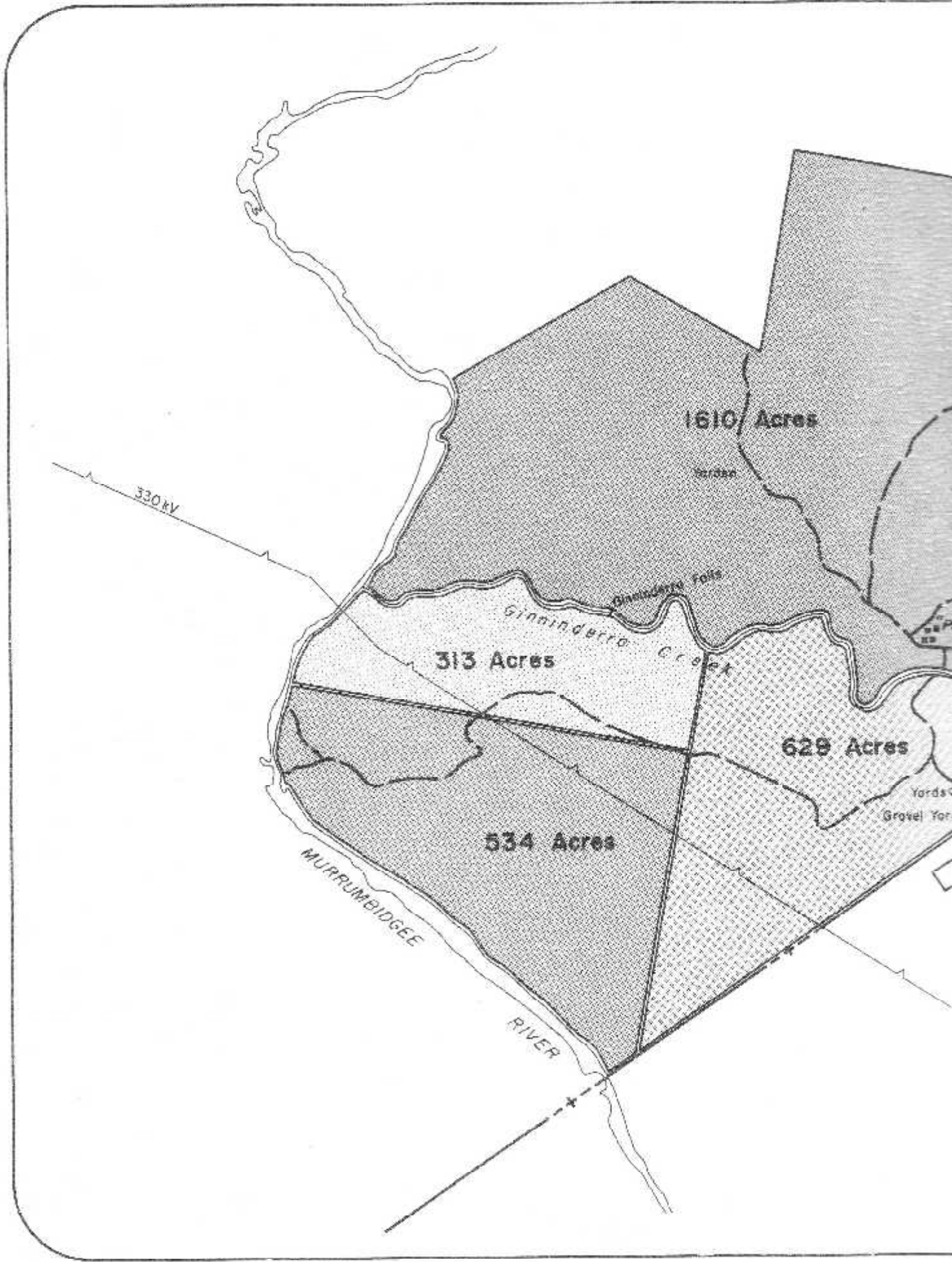

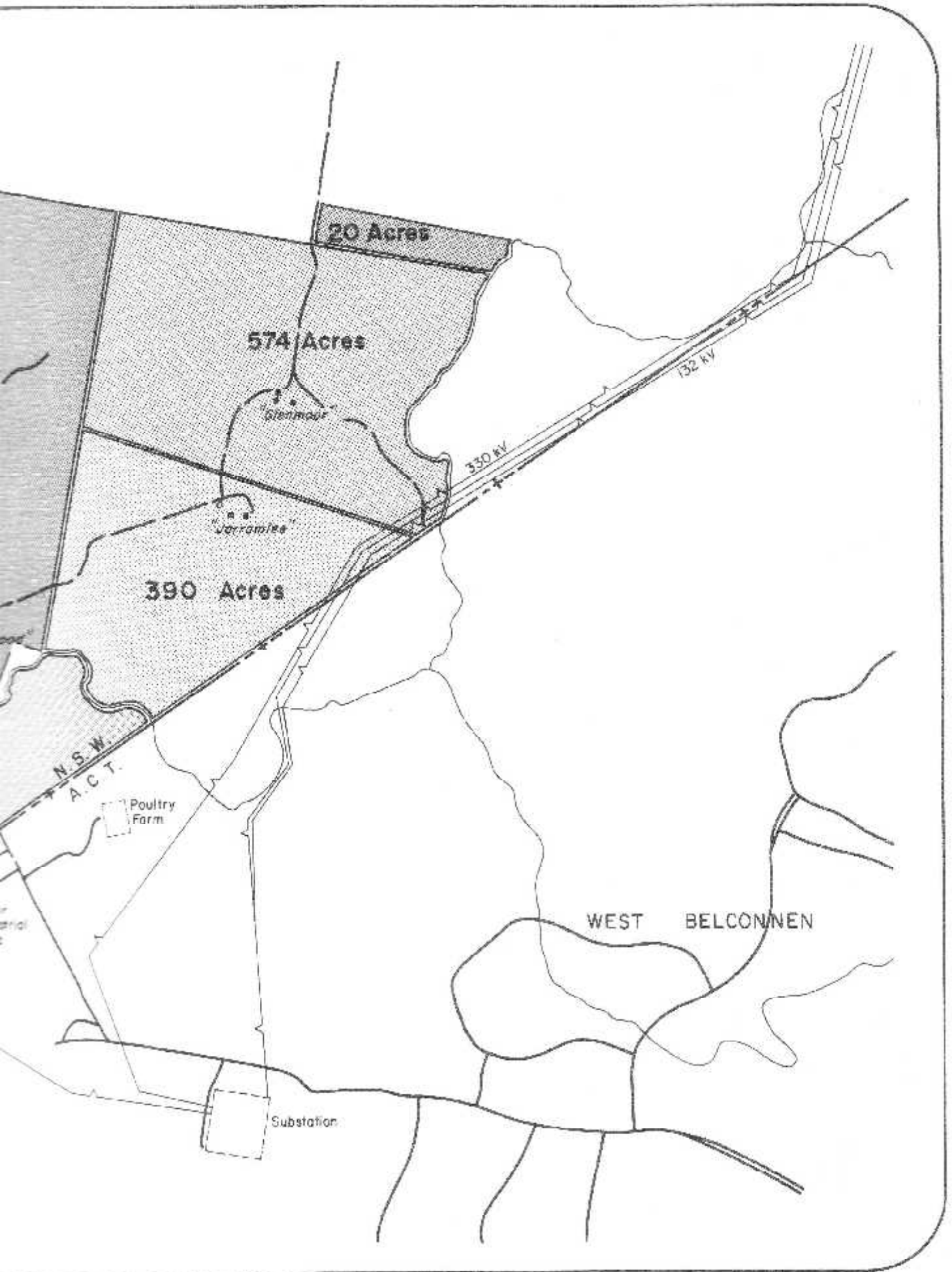

"Parkwood" 644ha (1610 acres) level to undulating and good grazing hills. Pasture improved. Approximately 500 acres arable, some green timber on river frontage. Brick and concrete home 3-bedroom, study, etc. Historic 1863 Sandstock brick house (needing restoration) vintage stone church, woolshed etc. Four-kilometre frontage to permanent Ginninderra Creek.

"Glenmoor" 232ha (574 acres) about one-third undulating to low grazing hills, balance heavily pasture-improved and arable with 1½-kilometre frontage Gooromon Creek. Sound weatherboard home, 3-4 bedrooms, etc., garages, sheds and stabling. Old shearers' quarters. Stylish block.

"Jarramlee" 150ha (390 acres) choice block, 60 per cent arable and sown down ryes, clovers, phalaris and some lucerne. Five hundred-metre frontage Ginninderra Creek. Stylish brick home of 3 bedrooms (one ensuite) in garden setting and protective Cyprus pines. Boundary to A.C.T.

Portion 3. 251ha (629 acres) mainly level, suitable variety cropping and pasture-improved productive soils. Well divided and 2 kilometres frontage Ginninderra Creek. Cattle yards. Long boundary A.C.T.

Part Portion 74, 213ha (534 acres) splendid mixture of level pasture improved and cleared grazing hills with magnificent 3-kilometre frontage to Murrumbidgee River including canoeing and fishing. Site of Cusacks Crossing. Block with exciting possibilities.

Portion 37 and 7, 126ha (313 acres) includes mostly level arable farming and fattening country with some green areas on frontage Murrumbidgee and 2 kms frontage Ginninderra Creek. Includes Ginninderra Falls tourist attraction.

Portion 13, 8 ha (20 acres) level farming — creek frontage.

Lic. Auctioneers in Conjunction

A.Y. Storrier
82 Queen St,
Woollahra, N.S.W.
(02) 32 5372
A.H. (02) 389 0438

P.W. Reid Real Estate Pty Ltd
Cinema Center, Bunda St,
Canberra City
49 7566
A.H. 95 8995



GINNINDERRA FALLS
AUCTION

Ginninderra Falls and the historic "Parkwood" grazing property could fall into the hands of developers and speculators who have little interest in preserving the geological, ecological, historical and recreational values of the area. It could be closed to public access.

If you are interested in preserving the area, you are invited to participate in a Trust Company which has as its objectives, the following:

1. To purchase the whole property.
2. To establish the logical extension of the Murrumbidgee River Corridor and the Ginninderra Creek Corridor at least to the confluence of the two waterways, to protect the natural environment through which they flow.
3. To preserve the Ginninderra Falls area as a tourist and recreation venue.
4. To progressively enhance the tourism and recreation facilities in an environmentally conscious manner.
5. To prevent the fragmentation of valuable and historical pastoral land.
6. To prevent encroachment of urban development on the ^{lands} areas of environmental and historical value.

7. To cooperate with the Yarrow/Orinla Shire Council, The N.S.W. Department of Environment and Planning, and A.C.T. Authorities in Planning the future of The area.

and other involved organizations

It is intended to issue shares in the Trust Company at \$500 each (~~maximum of five shares per family~~), and, if you are interested in pursuing these objectives, you are invited to respond immediately to the undersigned.

Dr Chris Watson - Ginninderra Community Council 545238 (h)
465962 (w)

Dierk von Behrens - Conservation Council of the 541763 (h)
South-East Region & Canberra 671341 (w)

Rob Caldwell - Ginninderra Falls 544053

Liz Caldwell - Ginninderra Falls 549637

Rudi Zimmermann -

477132.

Heather Vandenberg

31.